



QUEENSLAND MUSEUM

# Egyptian Mummies

## EXPLORING ANCIENT LIVES

16 March to 26 August 2018

BOOK NOW | [qm.qld.gov.au/mummies](http://qm.qld.gov.au/mummies) | #mummiesqm

Welcome to *Egyptian Mummies: Exploring Ancient Lives*

For directions and assistance during your Museum visit, please ask our Visitor Services Staff or Volunteers.

Schools and Groups entrance/bag store ..... Level 0  
Café Muse ..... Level 2

There are no toilets inside exhibition gallery. For nearest amenities:

Male and female toilets ..... Level 4, Level 2, Level 0  
Accessible toilets ..... Level 2, Level 0

**PLEASE NOTE:**

**This exhibition contains human remains.**

Queensland Museum is committed to providing a respectful environment when displaying human remains and ask visitors to refrain from photographing any human remains.

However, photography of objects is permitted within this exhibition for non-commercial purposes.

Find resources online to help plan your visit and support your students' learning experience:

<http://www.mummies.qm.qld.gov.au>

Funding for insurance has been provided through the Queensland Government Exhibition indemnification Scheme, administered by Arts Queensland.

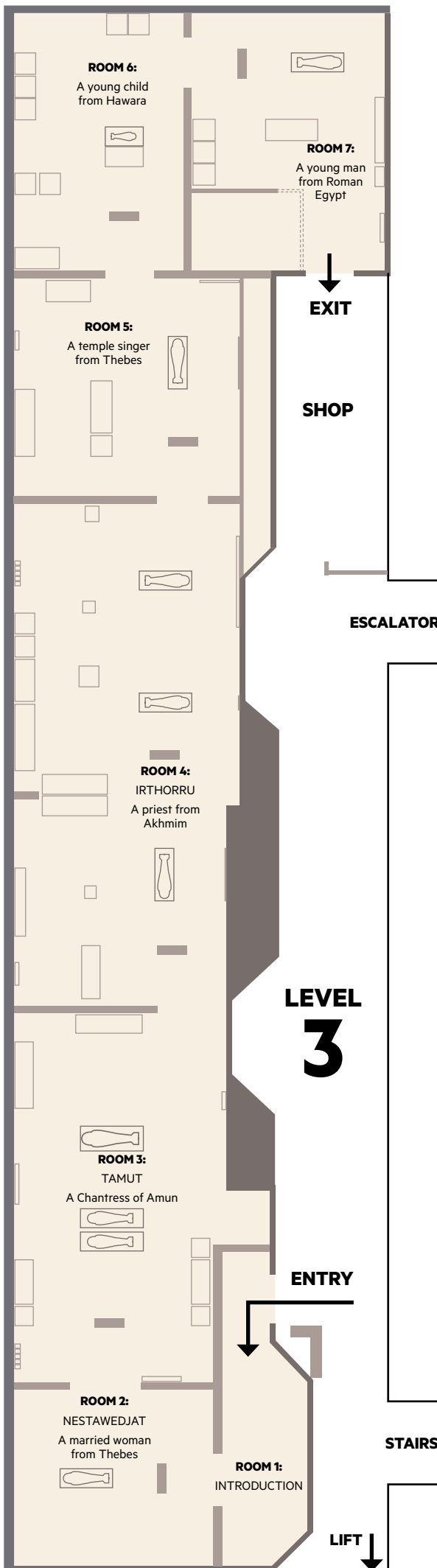

The British Museum

QUEENSLAND MUSEUM NETWORK

